

Access Guide: Can:Do 4Kids Hindmarsh

Where to find us

Address: 193-195 Port Rd, Hindmarsh SA 5007

Carparking available off West Street.

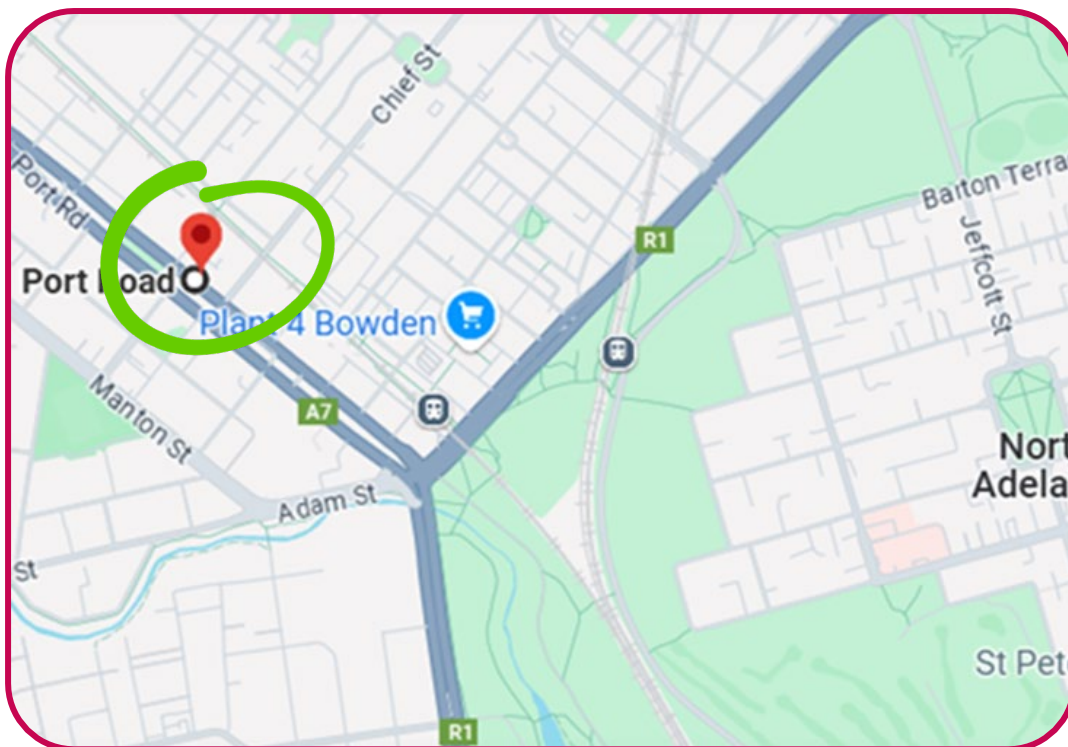

What you'll see:

- Look for **Can:Do Group** signage
- Enter through the **front** doors using the stairs on **Port Road**
- Or, enter via our **rear accessible entrance** off **West Street**

Step-by-step access directions

1. Arrive via **Port Road** and **turn left onto West Street** (off Port Road).
2. Drive down the **Right of Way (ROW)** beside the building.
3. **11 parallel car parks** (including **one accessible park**) are available along the ROW.
4. Designated accessible and parent park are available undercover, closest to the entry ramp.



Street parking nearby

- **West Street:** 5 unlimited-time parks
- **Anne Street:** 6 parks (2-hour limit)
- **Milner Street:** 14 parks (1-hour limit)
- **Chief Street:** 6 parks (2-hour limit)
- **First Street:** 4 unlimited-time parks + 10 parks (2-hour limit)

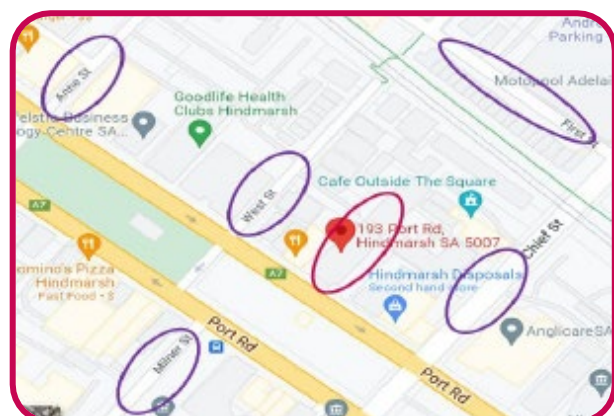

Finding reception desk

Reception is immediately visible when you arrive via the Port Road entrance.



Rear entrance to reception

1. Enter via access ramp where automatic doors will open.
2. Walk through the access hallway where another automatic door will open.
3. Walk past the stairs on your left and open the door to enter the reception area.



What to expect inside

We aim to create a **calm, sensory-aware** space:

Feature	What You'll Notice
Lighting	Warm and natural dimmable lights; no harsh or flickering lights
Noise Levels	Quiet environment with minimal loud or sudden sounds due to acoustic ceiling tiles. Occasional unexpected noise from other centre visitors may occur.
Smells	Low-fragrance, non-scented environment. Toilets have floral fragrances.
Toilets	Accessible toilets nearby.
Waiting Spaces	Low-sensory environment and quiet seating areas available
Seating	A mix of soft, firm, and armless seating
Assistance Animals	Welcome throughout the site

Support options available

We can provide extra support based on your preferences:

- ☐ Sensory-friendly waiting area
- ☐ Staff trained in deaf awareness
- ☐ Visual flashing alerts for emergency evacuations for deaf community



Toilets

Toilets are located past reception on the right-hand side of the corridor. Signage is on each toilet door.

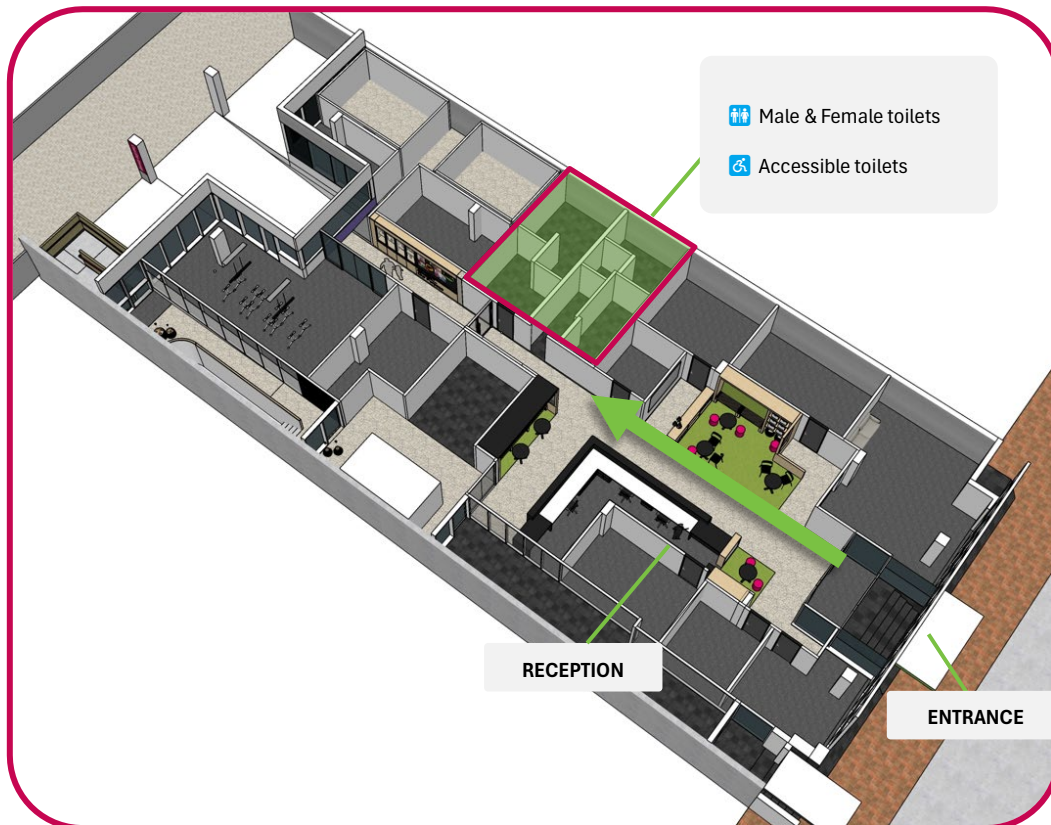

Parent/carer facilities

As a paediatric NDIS service provider, we understand the importance of creating a welcoming and accessible environment for families. Our facility includes two accessible toilets equipped with a change table and essential amenities to support carers of children who may require these facilities. These spaces offer a private, quiet area for changing and attending to your child's needs. They are designed to be pram-friendly and accessible for individuals using mobility aids, ensuring comfort and dignity for all families.



Contact us

Need support before your visit? **Phone:** [\(08\) 8100 8200](tel:0881008200)

Let us know if you would like:

- ☐ Someone to answer questions
- ☐ To provide feedback on our access guide please follow the link below:

<https://www.cando4kids.com.au/compliment-feedback-complaint/>